

# LED LINE INSTALLATION INSTRUCTIONS

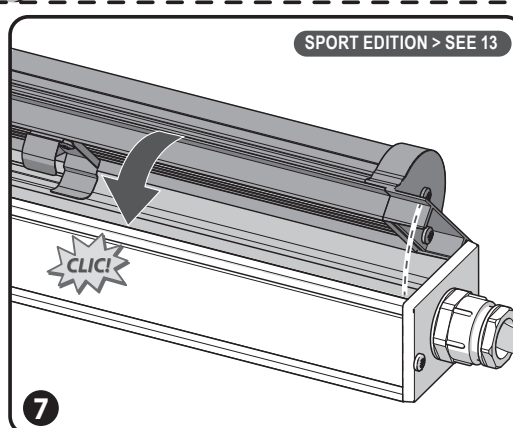
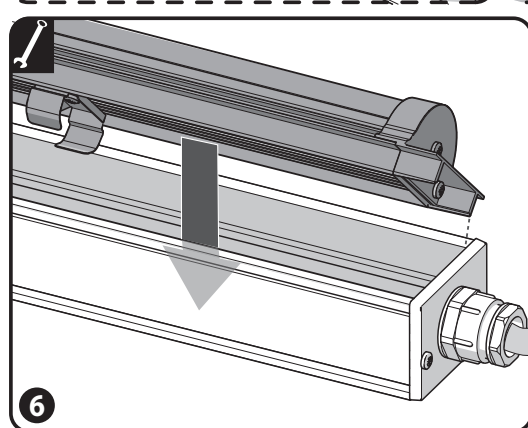
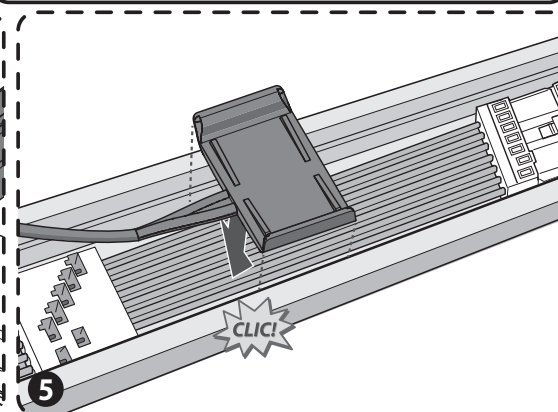
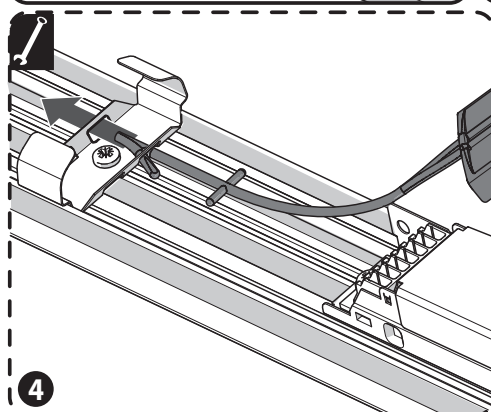
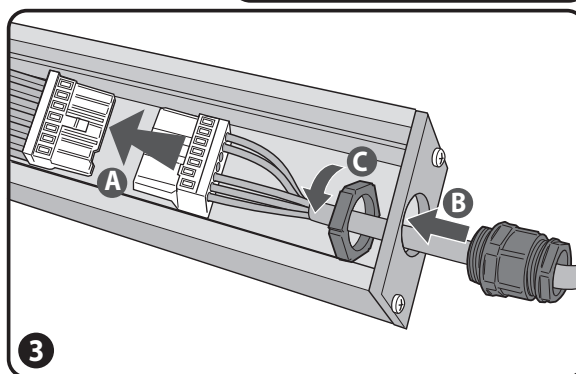
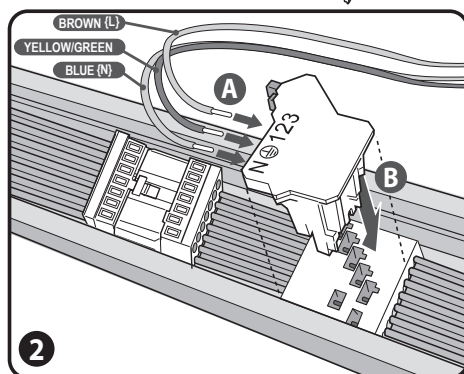
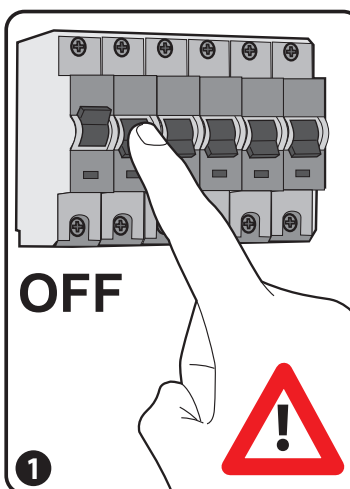
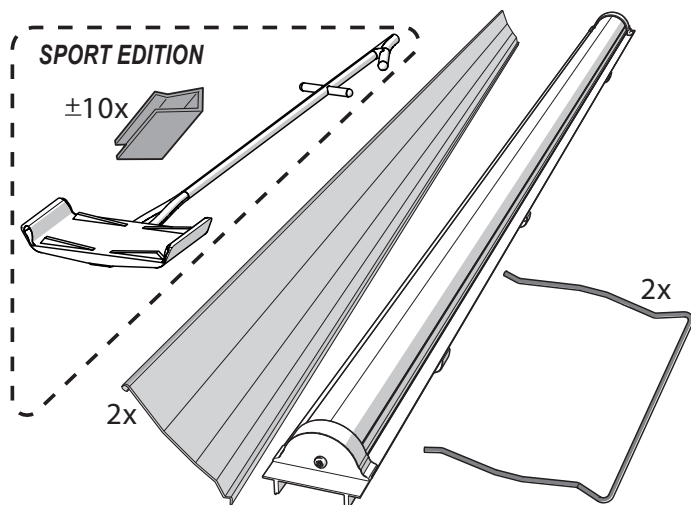

## INTRODUCTION

VEKO's LED line lighting can provide excellent light intensity at heights of up to 14 metres. Significant advantages of this line are the fast installation and long life span.

## INSTALLATION

[1] Disconnect the mains before installation!

[2] Insert the wires of the LEDs into the connector on N, ⊕, and L1/L2/L3 {A}. Mount the connector on the wiring harness of the light line {B}.

[3] Mount the 7-pin connector on the wiring harness {A}. Fit the protective sleeve into the profile {B} and tighten the coupling nut {C}.

[4] SPORTS EDITION: Thread the fall protection through the holes of the spring of the LED unit.

[5] SPORTS EDITION: Press the other side of the fall protection in the support profile and use it to secure the flat cable.

[6-7] Fit the LED unit onto the profile of the light line at an angle {A}.

# LED LINE INSTALLATION INSTRUCTIONS

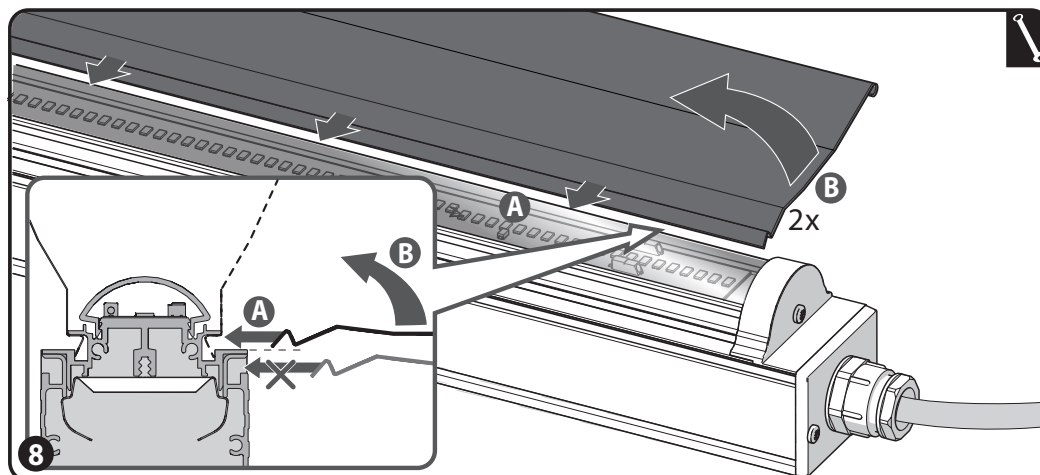

[8] Slide the two mirror reflectors into the top section of the profile {A} and turn them into the correct position {B}.

[9] Secure them in position by sliding the wire bracket into both sides of the mirror reflector.

[10] Remove the protective film from the mirrors. Take care not to touch them with your fingers.

[11] The number of suspension points should correspond with the number of luminaires to be installed.

[12] To clean the luminaire use only a cloth and a little water if necessary.

[13] SPORTS EDITION:  
Slide the clips over the rim of the profile and cover {B}.

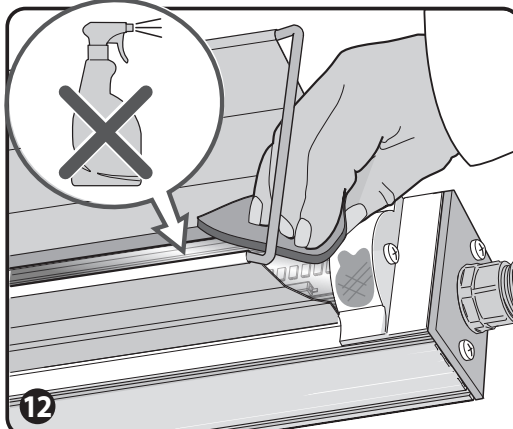
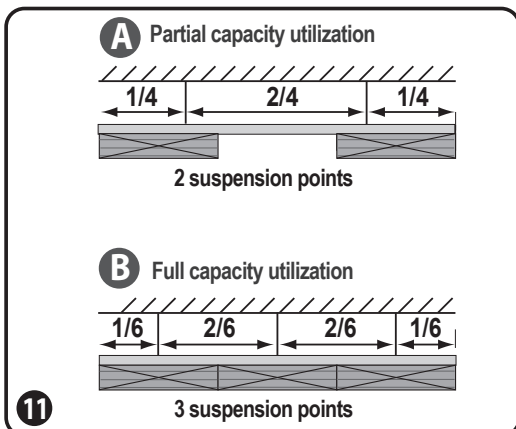
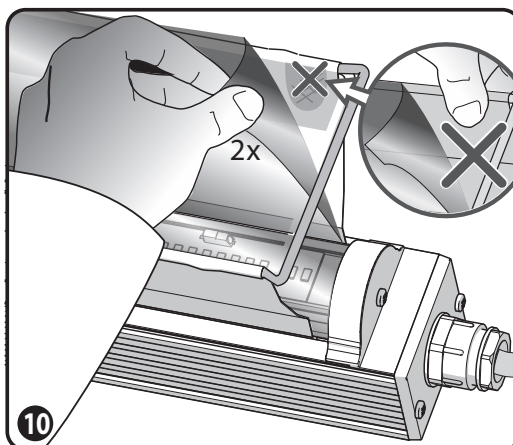
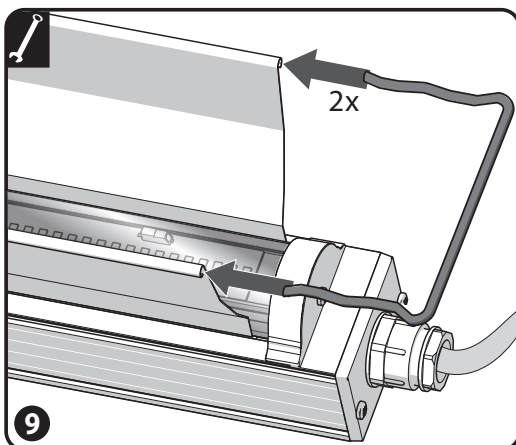

## IMPORTANT

Always disconnect the mains before dismantling/replacing the LEDS! Detaching the LEDs from the driver while they are live will damage them.

## SAFETY

Disconnect the mains before commencing installation of the light line.

Any work on the 230V-mains and/or the installation of the light line must be carried out by qualified electricians only.

All installation instructions must be followed.

When connecting the wiring, always take special note of the corresponding colours.

Take all technical specifications of the appliance into consideration.

If in any doubt, please contact Veko Lightsystems Technical Department.

If you have any questions about the installation e-mail [montage@veko.nl](mailto:montage@veko.nl) or call +31 (0)224 - 273 235

## TECHN. SPECIFICATIONS

Mains voltage: **230 - 240 V, 50 Hz**  
Subject to changes in design

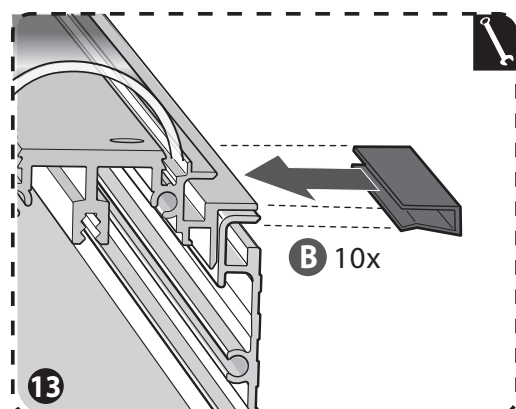

If you have any questions about the installation  
e-mail [montage@veko.nl](mailto:montage@veko.nl)  
or call +31 (0)224 - 273 235



For more information on Veko Lightsystems,  
product information and downloads,  
go to [www.veko.com](http://www.veko.com)